

S25 SERIES DP, 25° PA

Finishing, Disc Type Non-Topping

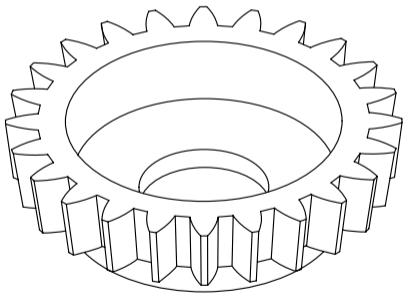

$$2.25/DP=WD$$

20DP & FINER - DEPTH IS $2.20/DP + .002$

Diam. Pitch	Pitch Dia.	Bore	No. Teeth	Whole Depth	Series
1-1/2	7.3	1-3/4	11	1	S25-150-7
1-3/4	6.8	1-3/4	12	1.2857	S25-175-7
2	4.5	1-1/4	9	1.125	S25-200-4
2	6	1-3/4	12	1.125	S25-200-6
2	7.5	1-3/4	15	1.125	S25-200-7
2-1/4	5	1-3/4	11	1.000	S25-225-5
2-1/2	4	1-1/4	10	.900	S25-250-4
2-1/2	5	1-3/4	13	.900	S25-250-5
2-1/2	6	1-3/4	15	.900	S25-250-6
2-3/4	5	1-3/4	14	.8182	S25-275-5
3	2.6	3/4	8	.750	S25-300-S
3	3	1-1/4	9	.750	S25-300-3

(continued on next page)

S25 SERIES DP, 25° PA (continued)

Diam. Pitch	Pitch Dia.	Bore	No. Teeth	Whole Depth	Series
3	4	1-1/4	12	.750	S25-300-4
3	5	1-3/4	15	.750	S25-300-5
3	6	1-3/4	18	.750	S25-300-6
3	6.6	1-3/4	20	.750	S25-300-7
3-1/2	3	1-1/4	11	.6429	S25-350-3
3-1/2	4	1-1/4	14	.6429	S25-350-4
3-1/2	5.1	1-3/4	18	.6429	S25-350-5
3-1/2	6	1-3/4	21	.6429	S25-350-6
4	2.3	3/4	9	.5625	S25-400-S
4	3	1-1/4	12	.5625	S25-400-3
4	4	1-1/4	16	.5625	S25-400-4
4	5	1-3/4	20	.5625	S25-400-5
4	6	1-3/4	24	.5625	S25-400-6
4-1/2	4	1-1/4	18	.500	S25-450-4
4-1/2	5.1	1-3/4	23	.500	S25-450-5
5	2	3/4	10	.450	S25-500-S
5	2.4	3/4	12	.450	S25-500-SA
5	3	1-1/4	15	.450	S25-500-3
5	4	1-1/4	20	.450	S25-500-4
5	5	1-3/4	25	.450	S25-500-5
5	6	1-3/4	30	.450	S25-500-6
5-1/2	4	1-1/4	22	.4091	S25-550-4
6	2	3/4	12	.375	S25-600-S
6	3	1-1/4	18	.375	S25-600-3
6	4	1-1/4	24	.375	S25-600-4
6	4	1-3/4	24	.375	S25-600-4L
6	5	1-3/4	30	.375	S25-600-5
6	6	1-3/4	36	.375	S25-600-6
6-1/2	4	1-1/4	26	.3462	S25-650-4
7	3	1-1/4	21	.3214	S25-700-3
7	4	1-1/4	28	.3214	S25-700-4
7	5	1-3/4	35	.3214	S25-700-5
8	1.8	1/2	14	.2813	S25-800-H
8	1.9	3/4	15	.2813	S25-800-S
8	3	1-1/4	24	.2813	S25-800-3
8	4	1-1/4	32	.2813	S25-800-4
8	5	1-3/4	40	.2813	S25-800-5
9	3	1-1/4	27	.250	S25-900-3
9	4	1-1/4	36	.250	S25-900-4
10	1.6	1/2	16	.225	S25-010-H
10	2	3/4	20	.225	S25-010-S
10	3	1-1/4	30	.225	S25-010-3
10	4	1-1/4	40	.225	S25-010-4
10	5	1-3/4	50	.225	S25-010-5
10	6	1-3/4	60	.225	S25-010-6
11	4	1-1/4	44	.2045	S25-011-4
12	1.5	1/2	18	.1875	S25-012-H
12	1.6	3/4	21	.1875	S25-012-S
12	3	1-1/4	36	.1875	S25-012-3
12	4	1-1/4	48	.1875	S25-012-4
12	5	1-3/4	60	.1875	S25-012-5
12	6	1-3/4	72	.1875	S25-012-6
14	1.7	1/2	24	.1607	S25-014-H
14	3	1-1/4	42	.1607	S25-014-3
14	4	1-1/4	56	.1607	S25-014-4
14	5	1-3/4	70	.1607	S25-014-5

(continued on next column)

Finishing, Disc Type Non-Topping

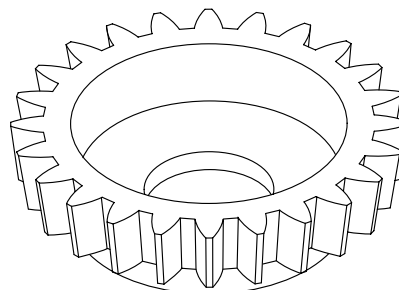

$$2.25/DP=WD$$

20DP & FINER - DEPTH IS 2.20/DP + .002

(continued from previous column)

Diam. Pitch	Pitch Dia.	Bore	No. Teeth	Whole Depth	Series
15	3	1-1/4	45	.1500	S25-015-3
16	1.5	1/2	24	.1406	S25-016-H
16	2	3/4	32	.1406	S25-016-S
16	3	1-1/4	48	.1406	S25-016-3
16	4	1-1/4	64	.1406	S25-016-4
16	5	1-3/4	80	.1406	S25-016-5
17	3	1-1/4	51	.1324	S25-017-3
18	1.4	1/2	26	.1250	S25-018-H
18	3	1-1/4	54	.1250	S25-018-3
18	4	1-1/4	72	.1250	S25-018-4
20	1.5	1/2	30	.112	S25-020-H
20	3	1-1/4	60	.112	S25-020-3
20	4	1-1/4	80	.112	S25-020-4
21	3	1-1/4	63	.1068	S25-021-3
22	3	1-1/4	66	.102	S25-022-3
24	1.3	1/2	32	.0937	S25-024-H
24	1.5	1/2	36	.0937	S25-024-HA
24	3	1-1/4	72	.0937	S25-024-3
24	4	1-1/4	96	.0937	S25-024-4
26	3	1-1/4	78	.0866	S25-026-3
28	3	1-1/4	84	.0836	S25-028-3
30	3	1-1/4	90	.0753	S25-030-3
32	1.25	1/2	40	.0708	S25-032-H
32	1.5	1/2	48	.0708	S25-032-HA
32	3	1-1/4	96	.0708	S25-032-3
32	4	1-1/4	128	.0708	S25-032-4
36	1.5	1/2	54	.0631	S25-036-H
36	2	3/4	72	.0631	S25-036-2
36	3	1-1/4	108	.0631	S25-036-3
40	1.5	1/2	60	.057	S25-040-H
40	3	1-1/4	120	.057	S25-040-3
48	1.5	1/2	72	.0478	S25-048-H
48	2	3/4	96	.0478	S25-048-2
48	3	1-1/4	144	.0478	S25-048-3
56	1.5	1/2	84	.0413	S25-056-H
64	1.5	1/2	96	.0364	S25-064-H